

# THE LYMINGE NEWSLETTER

For the communities of LYMINGE, ETCHINGHILL, RHODES MINNIS and POSTLING

September 2024

Produced by  
THE LYMINGE ASSOCIATION  
[www.lyminge.org.uk](http://www.lyminge.org.uk)

From The Lyminge Association

**S**

**GARAGE**

**L**

for garages in Lyminge and surrounding villages

**with TABLE SALE**

at Lyminge Village Hall

**Sunday 15th September**

starting at 9.00am

**E**

**BOOKING NOW**

Registration Forms available from Tuesday 27th August to Tuesday 10th September at  
**The Coffee Cabin** and **Snippers & Clippers**  
or download from [www.lyminge.org.uk](http://www.lyminge.org.uk)  
Closing date **Tuesday 10th September**  
For further information call Steve on 01303 863600  
*Organised by The Lyminge Association*

The  
Lyminge  
Association

# AGM

10th October  
7.30pm  
Lyminge Village Hall  
*Please try to give us your support.*

**GARAGE SALE**  
Map of locations will be available  
free from Lyminge Village Hall on  
the day or on-line  
[www.lyminge.org.uk](http://www.lyminge.org.uk)  
(from 7am on the day)  
**SUNDAY 15 SEPTEMBER**

## Daphne Andrews

It was with great sadness we recently learned of the passing of Daphne Andrews. She touched many people's lives in this community and it is fitting that a proper obituary is written in her memory. To that end, her obituary will appear in the October version of the Lyminge newsletter. Should you wish to contribute, then please send your memories and photographs to [lymingehistoricalociety@gmail.com](mailto:lymingehistoricalociety@gmail.com) by no later 10 September. Alternatively, they can be left or posted to my home address: Ivy Lodge, Woodland Road, Lyminge CT18 8EP and I will forward them to the authors. *Editor*

COMING SOON : Lyminge community to vote for their favourite Christmas Carol  
See October newsletter for further details.

# Margaret Saunders' Meanderings

I find myself with time to spare in Folkestone so decide to walk along the Leas and take the Metropole Steps that lead down the cliff. These wooden steps, 168 in total, have been the most direct route to the Coastal Park for over 100 years. This area in its heyday contained the Victoria Pier, a switchback, a miniature railway and a children's zoo. A noticeboard informs me that the Lower Leas Coastal Park was formed in 1784 by land slippage and was initially used for farming. Cows were grazed here and driven down a winding track which to this day is still known as 'The Cow Path'. Land slippage is also the cause of the current closure of the Road of Remembrance, which leads down from the town to the harbour.

Descending the steps I arrive at the Coastal Park. With the air heat-heavy, I find a shady bench and settle in my surroundings. A hazy horizon hides any shipping in the distance fusing sky with sea, the latter deep jade and the sky light azure. Restless rippling waves flow in from the east, with the occasional brush stroke of a white top. They tumble at right angles to the beach where the rocky breakwater creates shallows. Folkestone Harbour fog horn sends out an intermittent blast; a group of people are having fun together on the beach, laughing and chatting; waves gently lap on the shore and the cry of a seagull are the sounds I hear. Enjoying the universal pleasure of throwing stones into the sea, a little boy in red shorts, white tee-shirt and sunhat jumps up and down with excitement every time his pebble splashes into the water – a simple activity that never fails to please, judging by the number of adults that do much the same, except maybe for the gleeful jumping! Four swimmers laze in the shallows of the calmer water of the small artificially created bay which is protected by groynes made up of huge boulders, which serve the dual purpose of restricting the longshore drift as well as providing safer bathing areas.



Walking along the Coastal Path, I plunge at times into dark 'tunnels' created by stunted trees. A lone pine stands with a completely flattened top where constant onshore winds have stunted its upward growth. Weathered wooden benches along the route, carved into artistic shapes, provide plenty of resting places. Metal footprints set into the path are a reminder of Folkestone's military history, the instep of each footprint bearing the name of a serviceman and his date of death. Three wooden billy goats gruff stand in the grass as part of a children's trail. Flowers bloom in a wild patch above the path amongst grasses that wave and sway in the salt-tanged breeze. Encouraging mindfulness and meditation, a circular maze made up of stones set into the grass invites the onlooker to take time out to meander along its coiled path.



Going down the final set of steps I am now on the promenade with colourful beach huts either side of me. To my left the honey-coloured shingle stretches away towards the harbour whose lighthouse is visible at the end of Folkestone Pier. To my right the beach huts, in their cheerful colours, lead the way to Sandgate. None of the huts on this side is occupied and I look through their porches, which are in line, and the effect is of a rainbow-coloured rectangular passageway stretching into the distance. A speedboat races across the water, its bow slapping down onto the waves as it bounces along.

Reluctantly I climb back up the first set of steps, pausing at the top to take one last look at the view. Before ascending the long flight back up to the Leas I notice a huge Mediterranean looking plant spurting forth long dark red flower stems from pale green spear-like leaves. Bright red poppies are amongst the mixture of flowers bordering the road, making a colourful display.

Once back on the Leas I walk across the expanse of cut grass, past well laid out and ordered flower beds, a complete contrast from what lies below the cliff, just a few metres down. Looking up, the rich blue sky makes a perfect backdrop for the ornate white lampstands that line the Leas, an echo of the elegant Victorian era when this was the place to see and be seen and the Metropole and Grand Hotels were the places in which to stay. The Grand, where King Edward VII used to stay with his mistress Alice Keppel, is now under scaffolding, so we await the completion of works to see it returned to its former glory.

Today has been one of a run of warm sunny days at the end of June, perfect for meandering near the sea with its accompanying and welcome breeze.

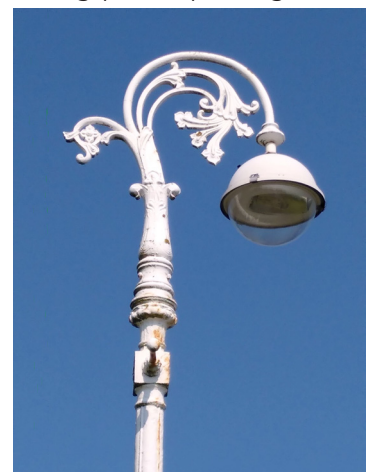



# Diary of Forthcoming Events

This page is printed to give readers and organisers the opportunity of planning events without clashing with existing ones, which are already in the 'diary'. It is not intended as a means of advertising and we take no responsibility for errors or omissions. Acceptance is at the discretion of the editor. Please send your updates by email to [pbarnes20@icloud.com](mailto:pbarnes20@icloud.com) or via methods outlined on Page 4.

Location and name codes below:

## One-Off Events

Date	Time	Event	Where	Tel. No.	Date	Time	Event	Where	Tel. No.
03-Sep	10am	Digital Support	AUKL	269602	12-Oct	7pm	Autumn Quiz	EVH	07544 670363
12-Sep	12.30pm	Dementia Café	AUKL	269602	19-Oct	6.45pm	Fun Autumn Quiz	EVH	
13-Sep	7pm	Music On A Friday BBQ	LPC		02-Nov	11am	Coffee Concert	LMC	
14-Sep	10am	Coffee and Cake Morning	PC		09-Nov	10am	Coffee and Cake Morning	PC	
15-Sep	9am	Garage Sale		863600	01-Dec	4.45pm	Christmas Lights Switch On	EVH	07544 670363
15-Sep	3pm	Rags to Riches' Concert	St Mary's, Elham		08-Dec	11am	Community Christmas Gathering	LPC	862073
21-Sep	6.30pm	Euro-Quiz (see P6)	ELVH		08-Dec	6.30pm	ERA AGM	EVH	07544 670363
28-29 Sept		Apple Pressing Weekend	EVLV		13-Dec	7pm	Music on a Friday - Christmas Concert	LPC	
10-Oct	7.30pm	Lyminge Association AGM	LVH	863737	14-Dec	4pm	Cantores - Christmas Concert	LVH	
12-Oct	10am	Coffee and Cake Morning	PC						

## Weekly Events

Day	Time	Event	Where	Tel. No.	Day	Time	Event	Where	Tel. No.
Mon	10am	Dementia Daybreak	AUKL	269602	Wed	10am	Dementia Day Break	AUKL	269602
Mon	10am	Bridge Club	LBC	863177	Wed	10am	Baby/Toddler Group	EVH	07817777975
Mon	10.30am	Maintenance Cognitive Stimulation Therapy (MCST)	AUKL	269602	Wed	11am	Singing For All (term time only)	AUKL	269602
Mon	10.30am	Lyminge Larks (Singing)	LMC	07951572920	Wed	2pm	French Conversation (fortnightly)	Call	862972
Mon	10.30am	Chromatic Greys Art Class	EVH	07783575802	Wed	7pm	Tayne Centre Circuits	TC	07925982995
Mon	1pm	Lyminge Knitters	AUKL	269602	Wed	7.30pm	Cantores Dominicae Choir	LVH	07778 333339
Mon	1.30pm	Maintenance Cognitive Stimulation Therapy (MCST)	AUKL	269602	Thurs	10am	Boxfit (non-contact)	AUKL	269602
Mon	5.15pm	Pilates	EVH	07951608008	Thurs	10am	Dementia Day Break	AUKL	269602
Mon	6.15pm	Pilates	EVH	07951608008	Thurs	10am	Lyminge Morning Art Group	EVH	01303211364
Mon	6.30pm	Ballroom/Latin/Salsa Dancing	TC	07966751991	Thurs	10.15am	Baby Rhyme Time	LL	03000413131
Mon	6.30pm	Judo Club	LVH	07369225021	Thurs	11.45am	Streetz to Streetz (fish and chips)	AUKL	07955926835
Mon	7pm	Yoga	RMV	07977503897	Thurs	2pm	Lyminge Afternoon Art Group	TC	07870494644
Tues	9am	Seated Yoga	AUKL	269602	Thurs	5pm	Pilates	TC	07951608008
Tues	9.30am	Tai Chi Qigong	EVH	07402203239	Thurs	6.15pm	Pilates	TC	07951608008
Tues	10am	Lyminge Baby & Toddler Group	TC	07870405567	Thurs	7pm	Short Mat Bowls	LVH	863842
Tues	10am	Painting and Drawing	AUKL	269602	Thurs	7.30pm	Ballroom and Latin Dancing	EVH	07967979610
Tues	10am	Dementia Day Break	AUKL	269602	Fri	8am	Chiropody (appointment only)	AUKL	269602
Tues	11.45am	Pilates	EVH	07834839801	Fri	9am	Pilates with Katherine	AUKL	269602
Tues	1.45pm	Pickleball	EVH	862696	Fri	9.30am	Dementia & Me Unit	AUKL	269602
Tues	3pm	Seated Yoga	AUKL	269602	Fri	9.15am	Nikki Barratt Art Group	EVH	07870494644
Tues	6pm	Board Games Night	Coffee Cabin		Fri	10am	Dementia Day Break	AUKL	269602
Tues	6.45pm	Short Mat Bowls	LVH	863842	Fri	10am	Painting and Drawing	AUKL	269602
Tues	7pm	Bridge Club	EVH	07790160476	Fri	10.15am	Talk Time	LL	03000413131
Wed	8am	Pilates	TC	07951698008	Fri	10.30am	Main Cog Stim Therapy (MCST)	AUKL	269602
Wed	9am	All Day Breakfast	AUKL	269602	Fri	6pm	Junior Cricket Training Sessions	SPCC	07869283195
Wed	10am	Pilates	TC	07825109670	Fri	7pm	Table Tennis	EVH	

## Monthly Events

When	Time	Event	Where	Tel. No.	When	Time	Event	Where	Tel. No.
1st Mon	2pm	RBL, Elham Valley Branch	St Mary's Hall Elham	862508	Last Tues	10.30am	Lyminge Poetry Group	LL	03000413131
1st Mon	10am	Stroke Support Group	C&H	07903150099	1st Wed	10.30am	Lyminge Friends	TC	862598
2nd Mon	7.00pm	Parish Council Meeting	TC	07544670363	1st Wed	2pm	Bingo	EVH	
3rd Mon	7pm	Etchinghill Cinema Club	EVH	07903150099	4th Wed	2.30pm	RM Circle	RVH	862913
3rd Monday	10am	Stroke Support Group	C&H	07715221705	Last Wed	7.30pm	Quiz Night	C&H	01303901011
1st Tues	2pm	Library Reading Group	LL	03000413131	2nd Sat	10am	Postling Ch. Coffee Morning	PC	863536
1st Tues <sup>3</sup>	7.30pm	LHS Talk/Event	TC	863879	2nd Sat	10am	Ethelburga Quilters	EVH	
2nd Tues	2pm	Library Reading Group	LL	03000413131	4th Sun	9.30am	Farmers' Market	LVH	
3rd Tues <sup>2</sup>	7.30pm	Gardeners' Society	TC	07703149008	3 monthly Sunday	10am	Blue Kangaroo Baby Class	EVH	07800 737936

<sup>1</sup> In term time only <sup>2</sup> Except Jan and Feb <sup>3</sup> Except Jan, Feb, and trip in Aug <sup>4</sup> Except Aug and Dec <sup>5</sup> Not held in August \*\* Every three months

**AUKL**: Age UK Lyminge; **C&H**: Coach & Horses; **EVH**: Etchinghill Village Hall; **ELVH**: Elham Village Hall; **ERA**: Etchinghill Residents' Association; **ES**: Elham Square; **EVLV**: Elham Valley Line Trust; **JF**: Jubilee Field; **KH**: Korf House; **LB**: Laing Bennett; **LBC**: Bowls Club; **LL**: Library; **LMC**: Lyminge Methodist Church; **LPC**: Lyminge Parish Church; **LPS**: Lyminge Primary School; **LVH**: Lyminge Village Hall; **LW**: Lord Whisky; **NP**: Nailbourne Court; **PC**: Postling Church; **PH**: Lord Whisky, Park House; **PVH**: Postling Village Hall; **RVH**: Rhodes Minnis Village Hall; **RMC**: Rhodes Minnis Church; **RMCS**: Rhodes Minnis Cat Sanctuary; **RR**: Rigden Room; **SMVH**: Stelling Minnis Village Hall; **SNL**: See Newsletter for info; **SP**: Sibton Park; **SPCC**: Sibton Park Cricket Club; **TC**: Tayne Centre; **TF**: Tayne Field; **WF**: Well Field



## St Mary and St Ethelburga Parish Church, Lyminge

### 1st September

Lyminge 10am WOW Service

Paddlesworth 6pm Evensong (BCP)

### 8th September **St Ethelburga's Day**

Lyminge 8am Holy Communion (CW2)  
6pm Choral Evensong for St Ethelburga

### 15th September

Lyminge 10am Holy Communion (CW1)

Paddlesworth 6pm Evensong (BCP)

### 22nd September

Paddlesworth 8am Holy Communion

Lyminge 10am Family Praise

### 29th September

Denton 10am Benefice Eucharist

### 6th October

Lyminge 10am WOW Service

Paddlesworth 6pm Evensong (BCP)

**If more information is required please contact the Church Wardens,  
Derek Smith 01303 862508 or Mike Chinneck 01303 863911**

### Rector's Message

Dear Villagers,

Over the summer months I've had the privilege of taking 4 weddings, 3 baptisms and 1 funeral. Each of them awesome occasions, celebrating life and love and placing loved ones into God's care.

As well as the big moments in life, the Church (the people as well as the building) is a tangible sign of God's presence with us in the everyday.

I am overwhelmed at the welcome, friendliness and hospitality you have extended to me as your new Rector.

It is this same generous welcome, reflective of our generous God, that I hope you will find across the churches in the benefice - one in which everyone is welcome, just as they are.

*Rev'd Carol Bates*



## Lyminge Methodist Church

A warm welcome awaits you at the following services to be held at **11am**, followed by a time of refreshment and fellowship.

**1st September** Rev Gill Songer

**8th September** **10.15am** Valley Service at Elham with Rev. Gill Songer

**15th September** Mr Dwight Harris

**22nd September** Local Arrangement

**29th September** Mr David Smith (incl. Holy Communion)

## Rhodes Minnis Chapel

A warm welcome is extended to anyone who wishes to join us for the following services at 9.30am in our small and beautiful Chapel and to share fellowship after the services over coffee and biscuits.

**1st September** A Local Arrangement

**8th September** A united Valley Service will be held at **10.15am** at Elham with Holy Communion led by Revd Gill Songer

**15th September** Mrs Val Redding

**22nd September** Mr Richard Blackwell

**29th September** Mrs Liz Talbot - A simple Harvest Service

**6th October** Mr Dwight Harris

*We will be greatly missing Daphne Andrews who passed away peacefully at the William Harvey Hospital on 16th August. She has been the mainstay of our little chapel at Rhodes Minnis for almost all her life and our treasured organist for the last sixty years. She will be irreplaceable. Do come and join us as we celebrate her work among us.*

## Postling Church Services

**1st September** No service in Postling

**8th September** 8.30am Morning Prayer

**15th September** 8.30am Holy Communion

**22nd September** No service in Postling

**29th September** No service in Postling

## Lyminge Newsletter

**Terms & Conditions: Copy deadline for next edition - 18 September 2024**

Please email your copy to the editor ([pbarnes20@icloud.com](mailto:pbarnes20@icloud.com)). Your payment must be received before your article or advert can appear in the Newsletter. Invoices will be issued and should be paid ASAP either by BACs, cheque, credit card or cash (details on invoice). **Business adverts** cost from £9.50 per month or £95.00 per year. **Personal and charity adverts and articles** from £3 per month, or £30.00 per year. The annual rate offers 12 entries for the price of 10. Please make cheques payable to '**The Lyminge Association**'. If you do not have email, a typed paper-copy may be left with the payment at the Library. Newsletter is printed by Canterbury Print & Mail.

**Lyminge Association accepts no liability for the accuracy of the advertisements or subsequent actions arising in conjunction with advertisers in the newsletter.**

**Further details from Peter Barnes (editor) on 01303 863737 or [pbarnes20@icloud.com](mailto:pbarnes20@icloud.com)**



## District Councillors' Update - September 2024

**Folkestone Sports Centre** – The news that Folkestone Sports Centre has gone into administration is extremely disappointing. The previous Conservative Administration funded a Business Plan for the Centre but I understand none of the recommendations were implemented. It could not have been at a worse time of the year, just when School holidays were starting and the swimming pool would be in high demand. With Hythe Pool maintenance costs constantly increasing, lets hope that the loss of the Folkestone Sports Centre Swimming Pool will not leave us without a Pool for the District!



**My Community Voice** – A further reminder to sign-up to Home Page - My Community Voice Kent. This is where you can find information on current scams locally and across Kent as well as other general information. For example, are you aware that Tamper Proof Screws for Vehicle Number Plates are available free of charge at Folkestone Police Station front counter? Folkestone front counter is open daily from 9am to 5pm, so go and get your screws!

**Sandgate Road Car Park** - Disabled motorists using the Sandgate Road Car Park can now register their vehicle for a quicker exit. Blue badge holders, eligible for three hours free parking, are being encouraged to register and upload a copy of their document onto the council's Autobill platform. Once approved, blue badge holders will then be able to leave without the need to visit a parking terminal.

**Ashford Constituency MP** – Recently I met Sojan Joseph our new MP for the Ashford Constituency. I was able to discuss with him the Otterpool Park Garden Town Project and the impact that the loss of the winter fuel allowance will have on some vulnerable residents. He noted my concerns and I wait to hear an update on both issues.

I attended Lyminge Parish council on 12 August.

**Contact:** [jenny.hollingsbee@folkestone-hythe.gov.uk](mailto:jenny.hollingsbee@folkestone-hythe.gov.uk) Mobile 07887918458 X (Twitter) @jennyhollingsbe

The draft of the updated **Corporate Plan for 2025 – 2030** is now available for consultation. Residents are being asked to comment on the Corporate Plan and consultation is open for 9 weeks until the 27th September. It is very important that you share your thoughts on it. The survey can be completed on-line. The draft plan and survey are also available as a printed booklet and can be obtained by contacting the council on 01303 853000 during business hours.

At the next **North Downs Forum** we will be discussing the draft of the update Corporate Plan. We will be meeting at Stelling Minnis Village Hall on the 3rd September at 7pm. Everyone is welcome to come along and join the discussion.

**Reach the Beach**, the free summer bus service between Folkestone West Station and the Harbour Arm, has been hugely successful. The numbers expected were 1000 passengers per week but during the first two weeks almost 2000 passengers used the service each week.

A recent briefing was held at **Otterpool Park** for the two new MPs. Sojan Joseph and Tony Vaughan both spoke of their excitement and commitment to delivering Otterpool Park which fits precisely into the new Government's Garden Town programme.

**Contact:** [elaine.martin@folkestone-hythe.gov.uk](mailto:elaine.martin@folkestone-hythe.gov.uk)

## Etchinghill Update - September 2024

### ETCHINGHILL RESIDENTS' ASSOCIATION (ERA)

Chairman: David McCombe - 07939 076617 E-mail: [dmccombel@gmail.com](mailto:dmccombel@gmail.com)

Website: [www.etchinghill.info](http://www.etchinghill.info) Facebook: Etchinghill Residents

### ERA FILM NIGHT AT ETCHINGHILL VILLAGE HALL - MONDAY 16TH SEPTEMBER.

#### FILM STARTS AT 7.30PM - DOORS OPEN 7PM. "ONE LIFE" (12).

Drama / History, starring Anthony Hopkins and Helena Bonham Carter. The stirring true story of Sir Nicholas 'Nicky' Winton, a young London broker who, in the months leading up to World War II, rescued 669 predominantly Jewish children from the Nazis in Prague in a race against time before the borders closed. Fifty years later, it's 1988 and Nicky lives haunted by the fate of the children he wasn't able to bring to safety in England; always blaming himself for not doing more. It's not until a live BBC television show, 'That's Life', surprises him by introducing him to some surviving children – now adults – that he begins to come to terms with the guilt and grief he carried for five decades. The entry fee is only £6 pp and includes a glass of wine, tea or coffee with biscuits and entry into a free raffle. New members are welcome, simply register and pay on the night - no need to book.

### ERA FUN QUIZ - ETCHINGHILL VILLAGE HALL - SATURDAY 19TH OCTOBER -

#### DOORS OPEN AT 6.45 PM FOR A 7PM START.

Please book your table early as this is always a popular event. TO ENSURE FAIR PLAY, 6 PERSONS PER TEAM MAXIMUM PLEASE. Entry is only £4 pp (no charge for children under the age of 18 or full time students). Please remember to bring your own refreshments as the kitchen will be closed. To reserve a place, or to donate a raffle prize, please contact Geraldine on 07544 670363 or email her - [gpmccombe49@gmail.com](mailto:gpmccombe49@gmail.com)

**UPDATE - CLOSED PLAY AREA ST MARYS CLOSE, MERIDEN PARK** - Thank you to Lyminge Parish Council for acting promptly to clear the overgrown playground. We look forward to work (hopefully) commencing in September to refurbish the playing area and the equipment.

**News contact: Jacqui Blandford – 07543 966830 or email: [jacqui.blandford@gmail.com](mailto:jacqui.blandford@gmail.com)**





## LYMINGE HISTORICAL SOCIETY

Our next meeting will be at 7.30pm on Tuesday 3 September at The Tayne Centre, Church Road, Lyminge CT18 8JA



### **King Henry VIII's castles on the Kent Coast** **Speaker: George Chittenden**

The meeting on Tuesday 1 October will be:

**The Age of Blackboards and Chalk:**  
**Life in local rural schools before the 1960s**  
**Speaker: Kevin Bailey of Hythe Museum**

#### Members Free

New members and visitors are always welcome  
Visitors: £4 Payable on the door

All our publications, including our latest volume Lyminge a History Part 13, are on sale at our meetings. We accept payments by cash or card.

The LHS Committee are deeply saddened to learn of the death of Daphne Andrews who gave so much of her time and energy to the society over many years. We are working with the Lyminge Association to prepare a suitable celebration of her life for publication in the October Newsletter.

# EUROQUIZ

**ELHAM Village Hall**

**Saturday, 21st September**

**Come to a Quiz with a difference!**

6.30pm start (open from 6pm)

Teams of 6-8 - bring & share supper

**£8 pp including welcome drink**

Raffle and prizes

Entry is by pre-registration. Click on the QR code for more details and to register in advance. Then join Guest List - East Kent for Europe: Euroquiz - Elham Village Hall



# A Little More Joy

## Eco-friendly gift boxes



Vibrant, environmentally conscious gift boxes that are kind to the planet. We also have a build your own option for a more bespoke gift.

10% Discount on your first order (**welcome10**).  
Local collection (Lyminge) can be arranged via email.

#### Contact details

Website: [www.alittlemorejoy.co.uk](http://www.alittlemorejoy.co.uk)

Email: [alittlemorejoyuk@outlook.com](mailto:alittlemorejoyuk@outlook.com)



## MEDITATION COURSES

**More and more people are learning to use the skills of meditation and their breathing as a way of supporting their health and wellbeing, keeping their minds fit and regulating their nervous systems.**

I invite you to join me on my next Mindfulness Meditation Course Commencing Saturday 5<sup>th</sup> October 2024  
Ending Saturday 23<sup>rd</sup> November 2024  
10.00am - 12.30pm for 8 Sessions  
Location: The Committee Room, Lymyne Village Hall

Alternatively, on a WEEKDAY EVENING  
Commencing Thursday 3<sup>rd</sup> October 2024  
Ending Thursday 21<sup>st</sup> November 2024  
6.00pm - 8.30pm  
Location: The Committee Room, Lymyne Village Hall

For more information and to book a place  
Contact Ellen: 07740857109  
Email: [ejgarrard2712@gmail.com](mailto:ejgarrard2712@gmail.com)  
<https://ellengarrard.co.uk/>







# The POSTLING COFFEE & CAKE MORNING IN AID OF THE PILGRIMS HOSPICE

Saturday 14th September 10am to 12noon at Postling Church

ALL DONATIONS GO TO THE PILGRIMS HOSPICE IN THEIR ENTIRETY - PLEASE BRING CASH

ETCHINGHILL RESIDENTS' ASSOCIATION

## Film Night

"One Life" Rated 12

Monday 16th September

Etchinghill Village Hall - 7 for 7.30pm

Entrance Fee £6pp

Open to new and existing members  
Free Refreshments and Raffle



[www.etchinghill.info](http://www.etchinghill.info)

### THANK YOU!

**Gerald Edward Darnley 10/4/1939 - 11/8/2024**

I want to express my sincere thanks to all of you within our community who have given me such care and love in the past few weeks leading to Gerry's passing. There are too many people to name individually but I have been especially touched by so many messages, cards, flowers and other tributes to him. Thanks especially to all those who shared his memorable funeral day with me, and for the wonderful contribution of the combined choir members.

*Val Darnley*

## The Sometimes Gallery

A Pop-up Art Gallery  
Every Saturday and Sunday  
12pm - 5pm  
St Mary's Hall, Elham

Showcasing local artists, creatives and makers  
Original artwork, limited edition prints & cards

[info@thesometimesgallery.com](mailto:info@thesometimesgallery.com)  
[www.thesometimesgallery.com](http://www.thesometimesgallery.com)



A dazzling show, featuring the foot-tapping rhythms of Ragtime and early jazz.

Virtuoso pianist Helen Crayford invites you on a whistle stop tour from 1890-1940 showcasing:

Scott Joplin

Jelly Roll Morton

George Gershwin

'Fats' Waller

*In period costume*

St Mary's Church, Elham

Sunday 15th September  
3pm

£12 on the door. Refreshments including delicious cakes, tea and coffee will be available.



## MUSIC ON A FRIDAY

AUTUMN BBQ AND CONCERT  
13th September

Lyminge Parish Church  
BBQ  
at 7pm

Free entrance, free BBQ  
and free wine  
All welcome

Christmas Concert will be 13th December



## "How to Commit the Perfect Murder"

An amusing talk by Guy Deakins

*You've committed the perfect murder, but how can you put the body to good use in the garden? In this popular and amusing talk, Guy presents a new spin on feeding your soil to feed your garden, by inviting the audience to put themselves into the mind of a murderer.*

Tuesday 17<sup>th</sup> September  
7:30pm at The Tayne Centre, Lyminge

Refreshments from 7:15pm

Look out for the Sunflower Competition results in the October Newsletter



For more information about the Gardeners' Society please email: [lymingegardeners@gmail.com](mailto:lymingegardeners@gmail.com) or call Anne on 07703 149008



CONNECTION  
TO  
COMMUNITY

Lyminge Friends

On 4 September we welcome **John Backwell** and his personal experience of "That Hill in Africa - Climbing Kilimanjaro at 70 – silly or sensible?!"

A typing error was made last month, on **2 October (NOT September)** eminent local author **Emma Batten** is coming to speak about "Discovering Lyminge through my Writing". Emma lives on Romney Marsh and her novels are all based in the local area.

Everyone welcome – Entry is £4 (including Tea/Coffee)

We are a friendly social group and welcome new members and visitors so just drop into a meeting, or if you'd like to talk to one of us first, please call 07904 157897. All meetings are held in The Methodist Church, Church Road, Lyminge from 10.30am to 12noon unless stated otherwise.

## Garage For Sale

Single garage in the centre of Lyminge for sale. Currently used for storage – well aired and bone dry.

£20,000 ono for private sale.

**07711675147**

## Rhodes Minnis Circle

At our June meeting Len Howell spoke about the fascinating 'Mappa Mundi' on display in Dover Castle's keep. The map was commissioned by English Heritage, based on actual 12th Century maps. We learned about the medieval view of geography and religion and how the maps were created. Handcrafted on calfskin, materials used include lapis lazuli, malachite, gold leaf and 'dragon's blood' (actually made from the root of a shrub!), On **28th August** members enjoyed an afternoon tea at **Folkestone Garden Centre**.

We normally meet at Rhodes Minnis Village Hall at 2.30pm and visitors are always welcome.

For further information contact:

**Lis Hirlemann 07590 913856.**

## Lyminge Judo Club

(Bushido Club registered)



We are a small friendly village club. We welcome and encourage both novices and skilled players and train every Monday evening at Lyminge Village Hall from 6.30pm. Open to all ages from 6 upwards - no upper age limit.

Juniors £2.50 per week; Seniors £3.50 per week. First session free, with no obligation.

Contact: **Craig Munn** email: [craig.munn1@yahoo.com](mailto:craig.munn1@yahoo.com)

Facebook: [www.facebook.com/Lymingejudoclub](http://www.facebook.com/Lymingejudoclub)



## Fifth Trust Update

[www.fifthtrust.co.uk](http://www.fifthtrust.co.uk)

We are seeking a new Trustee to join our board. We are looking for a Trustee who shares our passion for providing a safe and fulfilling way of life for students with learning disabilities. Our board meets four times a year. While previous Board experience is helpful, it's not essential; we will provide support to ensure you are fully equipped to contribute. We are particularly keen to hear from candidates with legal experience to engage in all aspects of the charity's governance, with a special emphasis on the legal implications of strategy and governance.

This voluntary role is both rewarding and stimulating, with travel and subsistence expenses covered. If you're interested, please contact our chair Suzanne O'Brien at: [suzanne@fifthtrust.co.uk](mailto:suzanne@fifthtrust.co.uk). For an informal discussion, please call CEO Nikki Marley on: 01227 831851.

PS Our new still rosé wine has arrived, produced from the Seyval grapes harvested from our Elham Valley Vineyard last year. So visit our café to pick up your bottle today.



Hythe Aqua Swimming Club has vacancies for potential competitive swimmers Level 7 and above. Join a Club with a nationally accredited swim programme. Lessons/Coaching sessions are held on Tuesday & Thursday evenings at Hythe Pool.

We also welcome adult length swimmers to our Adult training on Tuesdays & Thursdays at 9.00pm

To book your place

Email: [hytheaqua@btinternet.com](mailto:hytheaqua@btinternet.com) or checkout our website: [www.hytheaqua.org.uk](http://www.hytheaqua.org.uk) or [F/book](#)



AGE UK HYTHE

# BINGO NIGHT

**5.9.24 & 3.10.24**

Come join us for this fun bingo night, watch or play (to play you must be over the age of 18)  
No need to book, just turn up

**GAME | NIGHT | FUN**

Doors Open At 6pm Eyes Down 6.30pm

Hythe, Lyminge & Ashford  
Age UK Hythe  
Sanford House  
Stade Street  
Hythe, CT21 6BD

Free entry, £2 per book or  
£11 for 6 books  
(6 games a book)

Registered charity number 1125274. Company number 6589817. © Age UK Hythe, Lyminge and Ashford 2024.

## Drop-in to Get Digital

at Age UK Lyminge, 63 Station Road, Lyminge, Folkestone. CT18 8HQ





Whether you need support with using your tablet, the NHS app, or just getting online. **We can help.**



Between 10am and 12pm on the following Tuesdays:

- 5<sup>th</sup> March
- 2<sup>nd</sup> April
- 7<sup>th</sup> May
- 4<sup>th</sup> June
- 2<sup>nd</sup> July
- 6<sup>th</sup> August
- 3<sup>rd</sup> September
- 1<sup>st</sup> October
- 5<sup>th</sup> November
- 3<sup>rd</sup> December

**Remember to bring your device along with you!**  
For more information contact Age UK on 01303 269602.

## AGE UK - LYMINGE



# Art with Claire

**Every Tuesday**  
Age UK Lyminge,  
Everist Court,  
63 Station Road,  
Lyminge, CT18 8HQ  
**10am-12pm**  
**£13.20**





Registered charity number 1125274. Company number 6589817. © Age UK Hythe, Lyminge and Ashford 2024.



## Join us for All Day Breakfast

Every Wednesday  
9am - 2pm  
£6 pp - includes Tea/Coffee  
No need to book  
AGE UK Lyminge, Everist Court



Registered charity number 1125274. Company number 6589817. © Age UK Hythe, Lyminge and Ashford 2023.



# LYMINGE AND ELHAM VALLEY STROKE SUPPORT

Have you, a family member or a friend been affected by a stroke?

Come and join our informal support group.

For more information, to check the dates of meetings/events, or if you would like support but are unable to attend the meetings

Email: [Lymingestrokesocial@gmail.com](mailto:Lymingestrokesocial@gmail.com)  
or Telephone: 07846 177 409

Dates for next meetings

2<sup>nd</sup> and 16<sup>th</sup> September

*We usually meet on  
the 1<sup>st</sup> and 3<sup>rd</sup>  
Mondays of the  
month (except  
Bank Holidays) at  
The Coach and  
Horses, Lyminge  
10:00am until  
12:00noon*

## THE TOWER THEATRE FOLKESTONE

# SISTER ACT

Music by ALAN MENKEN  
Lyrics by GLENN SLATER

Book by  
CHERI STEINKELLNER  
& BILL STEINKELLNER

Additional Book Material DOUGLAS CARTER BEANE

13 - 21 September

This amateur production is presented by arrangement with Music Theatre International  
All authorised performance materials are also supplied by MTI [www.mtishows.co.uk](http://www.mtishows.co.uk)

BOX OFFICE 01303 223925 or [towertheatrefolkestone.co.uk](http://towertheatrefolkestone.co.uk)



The Tower Theatre, North Road, Shorncliffe, Folkestone CT20 3HL

Registered Charity 1180504

**4th Sunday  
of each  
month**

Sunday June 23  
Sunday July 28  
Sunday Aug 25  
Sunday Sept 22

9.30-12.30  
**LYMINGE  
VILLAGE  
HALL**

Editor: [pbarnes20@icloud.com](mailto:pbarnes20@icloud.com)

**Freshly Prepared  
Breakfasts & Light Lunches  
Home Baked Cakes  
Vintage Afternoon Teas  
Coffees Teas  
Takeaway Available  
Private Functions**

Open Tuesday to Friday

9am - 3pm

Saturdays, open 8.30am - 1.30pm  
(breakfasts only)

Dog Friendly

THE COFFEE CABIN TEA ROOM LTD.  
CANTERBURY ROAD, LYMINGE, KENT.

CT18 8HU. 01303 864222

Instagram @thecoffeecabintearoomltd

Find us on Google Maps



# ? QUIZ ? NIGHT

ENTRY IS ONLY  
£4 pp!

SATURDAY 19<sup>th</sup> OCTOBER  
**FUN AUTUMN QUIZ**  
ETCHINGHILL VILLAGE HALL  
Doors open 6.45 pm - 7 pm start

AN ETCHINGHILL RESIDENTS'  
ASSOCIATION EVENT



HAVE A GREAT  
TIME!

Join us for our Fun Autumn Quiz with a mix of general knowledge, themed & musical questions

The quiz is always a fun & very popular event so please book early - to reserve a table please contact Geraldine by email: [gpmccombe49@gmail.com](mailto:gpmccombe49@gmail.com) or call 07544 670363

*In the interest of fair play, please ensure there are no more than 6 players in each team*

Entry fees are payable on the night - no charge for full time students or children aged under 18

Please bring your own snacks and refreshments as the kitchen will be closed

Raffle prize donations will be gratefully received - please contact Geraldine to arrange

*Funds raised will be used by the ERA for the benefit of the local community or various national & local charities*

Railway Museum  
THE  
ELHAM VALLEY  
LINE TRUST  
Countryside & Craft Centre

Admission  
Free

## Traditional Apple Pressing Weekend

Saturday 28th &  
Sunday 29th September  
2024

Tea Room ~ Hot and Cold Refreshments

Crafts ~ Gift Shop

Miniature Live Steam Engines

Miniature Train Rides

Weather and availability permitting

Model Shop ~ Sideshows ~ Games

Railway Museum

Entry Fee applies

[www.elhamvalleylinetrust.org](http://www.elhamvalleylinetrust.org)  
Registered charity No.295563

Information correct at time of printing

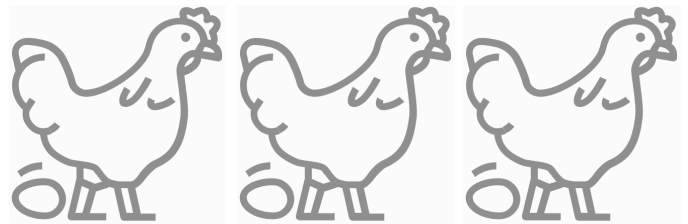

Chickens for Sale  
Longland Farm, Elham

Good quality Hybrid Laying Hens  
Various colours available  
Easy to keep, reliable layers  
Friendly birds

07825 181870  
[hello@longlandfarm.co.uk](mailto:hello@longlandfarm.co.uk)

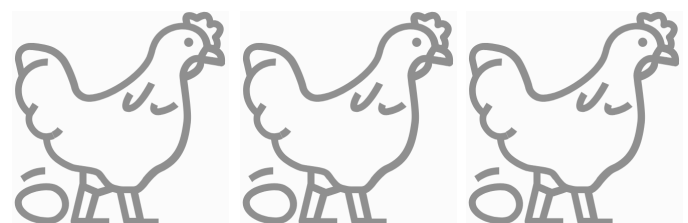



# ENVISAGE GROUND CARE

## Domestic & Commercial

- GRASS CUTTING
- HEDGE CUTTING
- CLEARANCE
- TREE WORK
- FENCING

**Tel: 07724 447 368**

**Email:**

**[enquiries@envisagegroundcare.co.uk](mailto:enquiries@envisagegroundcare.co.uk)**

**[www.envisagegroundcare.co.uk](http://www.envisagegroundcare.co.uk)**

## Anna Lindley (RVN, Dip.A.Physio)



**Anna's Animal  
Physiotherapy**

For dogs, cats & small pets



- Offering physiotherapy assessment and treatment of dogs, cats and small animals.
- Physiotherapy can help with osteoarthritis and the ageing pet, post operative orthopaedic surgery, neurological, spinal conditions, unexplained lameness and many more conditions.
- I use a combination of manual therapy, laser, ultrasound therapy, TENS, kinesiology tape and exercises to rehabilitate your pet depending on your their needs. I also address environmental and exercise factors that can help your pet with their condition.
- I am fully insured with over 16 years experience working with animals. I am a member of the International Association of Animal Therapists (IAAT).
- For more information please visit my website: [annasanimalphysio.co.uk](http://annasanimalphysio.co.uk) or feel free to contact me on 07944 606453 or [anna@annasanimalphysio.co.uk](mailto:anna@annasanimalphysio.co.uk)
- Why not follow me on social media:  
Instagram: [@annas\\_animal\\_physiotherapy](https://www.instagram.com/annas_animal_physiotherapy),  
Facebook: [@annasanimalphysiotherapy](https://www.facebook.com/annasanimalphysiotherapy)

*Christmas Goose*

Local produce from  
Longland Farm, Elham

Premium Quality & Welfare  
Environmentally Caring

Great Taste Award 2022  
Small 4-5kg • Medium 5-6kg  
Large 6-7kg  
£20/kg

07825 181870  
[hello@longlandfarm.co.uk](mailto:hello@longlandfarm.co.uk)  
£20 deposit payable  
Collection 23 Dec

## MOBILE FISH & CHIP UNIT

- School Fetes
- School Proms
- Kids Parties
- Fish Suppers
- Weddings
- Christenings
- Baby Showers
- Birthday Parties



- Boot Fairs
- Charity Events
- Quiz Nights
- Festivals
- House Parties
- Garden Parties
- Corporate Events
- Workplace Breakfasts

**07955 926 835**  
**[kingjaneil@aol.com](mailto:kingjaneil@aol.com)**



# LYMINGE PARISH COUNCIL

Etchinghill - Lyminge - Rhodes Minnis

[www.lymingeparishcouncil.org.uk](http://www.lymingeparishcouncil.org.uk)

[clerk@lymingeparishcouncil.org.uk](mailto:clerk@lymingeparishcouncil.org.uk)



Agendas, minutes and relevant reports are published on the council website. If you would like a copy of council documents please contact the clerk.

## **MERIDEN PARK:**

Last month we reported that work would begin in September; the contractor has now informed us that the work will begin towards the end of October.

## **NEIGHBOURHOOD PLAN:**

Our first official NHP committee meeting will be taking place on 12 September at 18:30 - venue to be confirmed.

## **RHODES MINNIS PLAY PARK:**

We are holding a meeting to discuss the refurbishment of Rhodes Minnis play park. We are hoping this will be in the first week of October (date and venue to be finalised). If you would like to be involved please contact the Clerk, we are particularly keen to work with the residents of Rhodes Minnis on this!

## **ALLOTMENTS:**

As mentioned previously, the allotments are currently having a bit of a make-over. In anticipation for the make-over being completed we will be starting to look at our waiting list and assign plots. At present the number of plots will be greater than the number on the waiting list. We know allotments can be time consuming so we have included some smaller plots for the hobby gardeners out there. If you would like to be added to our waiting list, please contact the Clerk and discuss your requirements! For those who aren't aware, our allotments are at the end of Fordred Lane in Rhodes Minnis.

## **GRANTS:**

We were delighted to approve a grant for Etchinghill Village Hall recently. The grant is to help improve the hall and allow for even more activities to take place! We love supporting our community and are still welcoming grant requests. The form is available on our website or by contacting the Clerk.



## **JOIN THE COUNCIL**

We still have open spaces on the parish council and would welcome applications to join. Lyminge Parish Council is a rare council in that it has a very even spread of ages, abilities, sex and experience. Though being a councillor can seem nerve-wracking, it is an interesting and varied role and is less time consuming than you think! If you are interested in joining, come to our meetings and see what you think or email the Clerk!



## CONTACT INFORMATION

General - [clerk@lymingeparishcouncil.org.uk](mailto:clerk@lymingeparishcouncil.org.uk) / 07999 403948

Handyman - [fred@lymingeparishcouncil.org.uk](mailto:fred@lymingeparishcouncil.org.uk)

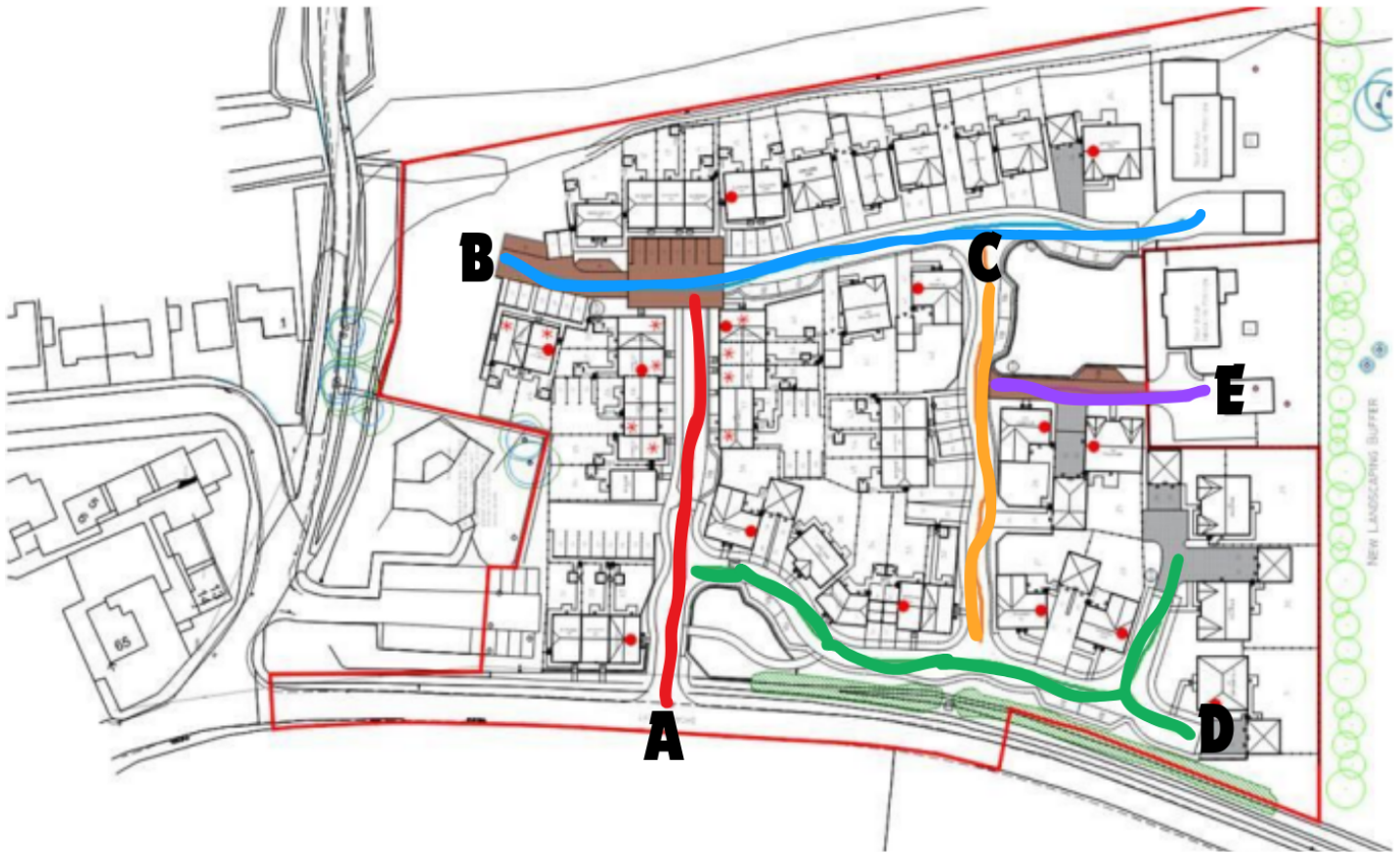

### **BROAD STREET DEVELOPMENT:**

A few months ago we shared that we had worked with Lyminge Historical Society to produce suggested street names for the Broad Street development. It has been confirmed that all of the new names are names we suggested (subject to Royal Mail approval).

A- Harrington Grove - In honour of Duncan Harrington.

B - Eight Acres - After the original field name.

C - Gessens Drive - After the original field name.

D - Thistley Close - After the original field name.

E - Rigden Mews - After the family who originally owned Broad Street Farm.

While the development itself has been contentious, there is no denying that the new development will be linked to our rich history. We are thankful that Pentland Homes have worked with us on this.

### **SIBTON MEADOW CAMP SITE:**

It has been brought to our attention that a short term camp site has opened in a field off Longage Hill. We are currently liaising with FHDC about this. So far it all appears to be above board but we will keep the parish updated on this as concerns have been raised.

## UPCOMING MEETINGS

FINANCE AND ADMINISTRATION - 2 SEP - 18:30 - LYMINGE METHODIST CHURCH (LMC)

CLIMATE ACTION - 2 SEP - 19:30 - LYMINGE METHODIST CHURCH

FULL COUNCIL - 9 SEP - 19:00 - LYMINGE METHODIST CHURCH

NEIGHBOURHOOD PLAN - 12 SEP - 18:30 - VENUE TBC

PLANNING AND LICENCING - 26 SEP - 9:30 - ETCHINGHILL VILLAGE HALL



## Thoughtful Food...

...is a group of local volunteers looking at our food, and how this impacts climate change. Our aims are to support people to produce more of their own food, and to shop locally, sourcing seasonal produce. We also run a community allotment in Lyminge and welcome new members.

**Contact:** [thoughtfulfoodgroup@gmail.com](mailto:thoughtfulfoodgroup@gmail.com) or on Facebook and Instagram [@thoughtfulfoodgroup](https://www.instagram.com/thoughtfulfoodgroup)

Next **Thoughtful Food** meeting, **Tuesday 3rd September, 7.30pm**, at the Coach and Horses Public House

It is with sadness that Thoughtful Food has had to cancel this year's Surplus Saturday due to be held on the 7th September due to a lack of surplus. This is usually a popular event on Tayne Field offering an opportunity for the local community to pick up surplus food grown nearby and pick up cooking and growing tips. Having said that the recent hot weather has really brought on growth and there may be informal offers of surplus. Check out our Facebook page.

This year's poor harvests have been a tangible wakeup call that we have to act now if we are to have any chance to preserve our precious and fragile earth. We will be launching a series of short articles in the newsletter around permaculture, a sustainable approach to life and gardening that mimics nature and works in harmony with natural cycles. Watch this space in future newsletters to find out more.

## Ultra Processed Food Snack Replacement

Snacks have got a little out of hand, starting with a few biscuits at morning coffee, plus a piece of Millionaires' shortbread when you go shopping, add the afternoon Muller Corner with chocolate balls and to finish the evening, some Pringles while watching a film, and you are way-y-y into too much food, or more accurately, food like substances. Deciding to discard the Pringles and substitute real food has not been made easy for us. The food companies design products that we just can't have one of, and before you know it, the packet is empty!! Next month some main meal swaps to lessen UPF consumption.

UPF Snack	Substitute
Biscuits with coffee	Homemade, low sugar biscuits. Make up a batches and freeze. Bring out as needed; cook from frozen.
Shop bought Yogurt	Purchase live yogurt that has no additives (Yeo, Tim's, Rachael's) the vanilla is often less sour and Greek style is thicker. Homemade yoghurt with added fresh or frozen berries.
Millionaires' shortbread and cake	Try and only frequent coffee shops that use homemade cakes. The Coffee Cabin in Lyminge is a great example.
Crisps to watch a film	Pop your own popcorn. Kale crisps. Carrot sticks with smashed avocado dip. Apple and cheese slices

## Tried and Tested Cooking Hacks

Last month this page featured how to easily make a basic tomato sauce. Here are a few ways to make use of your sauce. Hopefully you have some in the freezer, so it just needs defrosting!

Add some good quality stock, Kallo organic stock pastes are a good shout, some tomato puree. Liquidise. Instant tomato soup.

Add a tin of haricot beans or other pulses, some seasoning of your choice, tomato puree. Homemade made baked beans. If you want the beans to be orange like the Heinz variety cook them long and slow either on the hob, in the oven or in a slow cooker until the sauce becomes unctuous.



## PIZZAS !!!! Now this needs a little bit of planning but well worth it.

In the morning, in a large bowl make up a packet bread mix following the instructions on the packet. A packet will make 2 large thin pizzas so you might only need half a packet. The dough can be done in about 5-7 minutes as there is no measuring of ingredients and not too much mess to clean up. The packets do contain a few added ingredients but not much more than you would add to flour if you were making your own bread. Cover with a damp cloth and just leave, you don't need to worry about it being warm.

At dinner time. You will need a hot oven, so turn it on to 220°C. Oil a flat tray or pizza stone with good quality oil, doesn't have to be olive oil. Be quite liberal.

Knead your dough together, it should have risen quite a lot as it's been sitting out all day. Form a ball on a generously floured surface. If you used half a packet, you should use half the dough per pizza. Roll, spin, pull, have fun making it into a flat circle around 12 inches diameter. Spread on your tomato sauce and then add your favourite toppings. Get the kids involved. Let them have a quarter, half or whole depending on how hungry they are.



Bake until all your cheese or whatever is golden and dough is cooked. Should be around ten to fifteen minutes.

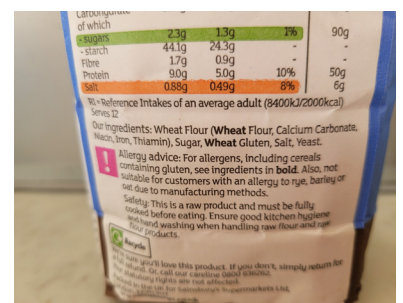

## Very Best Seasonal Wishes from Thoughtful Food





# All you need to know about Energy Performance Certificates (EPCs)

Much like the multi-coloured sticker on new appliances, Energy Performance Certificates (EPCs) tell you how energy efficient a building is.

EPCs rate a home from A (very efficient) to G (inefficient). They'll tell you how costly it will be to heat and light your property, and what its carbon dioxide emissions are likely to be.

An EPC also includes information on what the energy efficiency rating could be if you made the recommended improvements. It also highlights cost effective ways to improve your EPC rating.

EPCs are legally required when selling or renting properties in the UK.

## What each rating means for homeowners:

A higher rating, like A or B, shows that the property is energy-efficient. This leads to lower fuel bills and reduced carbon emissions. On the other hand, a lower rating, such as F or G, indicates high energy use. This often results in higher running costs and a larger carbon footprint.

The impact of ratings on energy costs: Properties with better EPC ratings usually have lower energy costs. Such homes need less energy for heating, cooling, and lighting. Investing in energy efficiency improvements can boost a property's EPC rating. This can lead to decreased ongoing energy expenses.

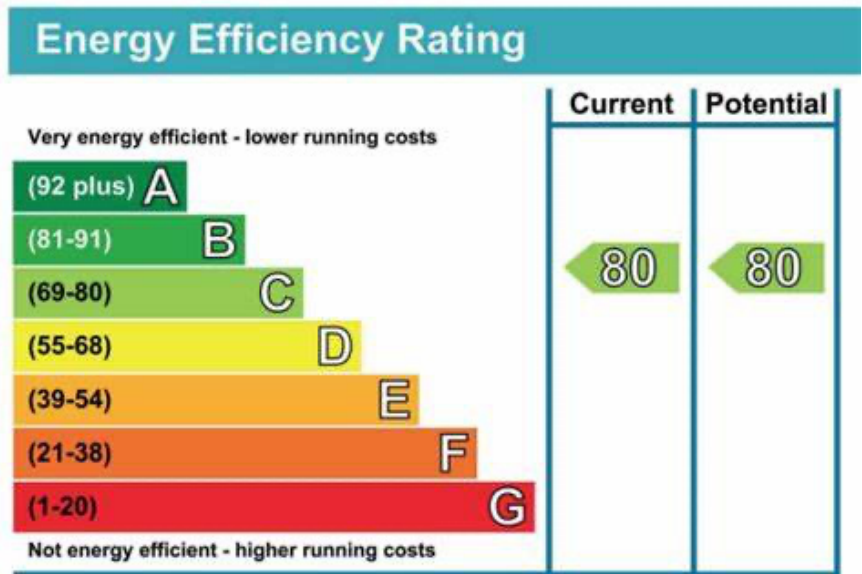

To find out if your property has an EPC visit [www.gov.uk/find-energy-certificate](http://www.gov.uk/find-energy-certificate)

**HUG**

**Register an interest TODAY**

**for FREE upgrades!**

Don't miss out on **fully-funded** energy-saving upgrades for your home.

**#SAVEENERGYSTAYWARM**

**DELIVERED BY:**  
Department for Energy Security & Net Zero

## Home Upgrade Grant

Time is running out to apply for free energy-saving home upgrades!

Householders have until the end of September to register an interest in the Home Upgrade Grant, so be sure to check you if are eligible and apply now.

Eligible homeowners could receive improvements to help save energy and cut energy bills.

Find out more [www.hugapply.co.uk](http://www.hugapply.co.uk)





# Home Instead.

*To us, it's personal*

**01303 847899**



CARE professional with client and Grandson

*Live well, your way  
with care at home*

- Personal Care
- Companionship Care
- Home Help
- Dementia Care
- End of life Care
- Live in Care

**Home Instead**

Folkestone, Hythe & Ashford

300 Cheriton Road

Folkestone, Kent, CT19 4DP

accounts.folkestone@fha.homeinstead.co.uk

www.homeinstead.co.uk/folkestone

# E.F.LETTINGS

Residential & Student



## YOUR LOCAL LETTING AGENT

At EFLettings we believe in a personalised service  
We are here for you every step of the way

www.eflettings.co.uk

Tel: 01227 533550

## Daniel Kirby Roofing & Building



Quality materials and reasonable rates  
Established 1996, based in Hawkinge, Near Folkestone,  
and covering Folkestone and Hythe areas  
Embracing all roofing work from small roof repairs to  
complete re-roofs.

What we do:

- Fibreglass Reinforced Plastic flat roofs
- Felt flat roofs
- New pitched tile and slate roofs and repairs
- Small and large jobs
- Fascias soffits and gutters
- Chimney repairs, rebuilds and removal
- Conservatory conversions
- Advice and free quotes

Visit full website below for more details

[www.roofers-folkestone.co.uk](http://www.roofers-folkestone.co.uk)

**01303 892705    07916273886**



# Kent's Leading Mobility Specialists

Over 200 new & used scooters available

**USED SCOOTERS FROM £395**

**BEDS FROM £1395**

**CHAIRS FROM £595**

Huge range of Shoes & slippers for problem feet

**HOME DEMONSTRATION LET US COME TO YOU**

**STAIRLIFTS**



**FOLKESTONE STORE**

**Tel: 01303 274574**

**[www.safehandsmobility.co.uk](http://www.safehandsmobility.co.uk)**

**[folkestone@shmobility.co.uk](mailto:folkestone@shmobility.co.uk)**

Compass House, 347-349

Cheriton Road, CT19 4BP

**ALSO AT  
BIRCHINGTON**



## HEAVER & LINCH

Bespoke Handmade Kitchens & Furniture

Bespoke Handmade Cabinet Makers based in Lyminge, covering Kent and the South East.

Over 30 years experience in creating stunning solid wood kitchens and furniture.

Get in touch for any advice, recommendations and a free quote.

**Tel: 07832 360 603 or 07832 363 963**

**Email: [heaverlinch@outlook.com](mailto:heaverlinch@outlook.com)**

**Website: [www.heaverandlinch.co.uk](http://www.heaverandlinch.co.uk)**



Editor: [pbarnes20@icloud.com](mailto:pbarnes20@icloud.com)

18

Don't be led up  
the garden path...

...choose an agent  
that gives straight  
forward, honest advice.



Call today for a free, no obligation valuation

Bridge Office - 01227 831999  
[bridge@colebrooksturrock.com](mailto:bridge@colebrooksturrock.com)  
88 High Street, Bridge, CT4 5LB

Elham Office - 01303 840422  
[elham@colebrooksturrock.com](mailto:elham@colebrooksturrock.com)  
Bank Buildings, Elham, CT4 6TD

[colebrooksturrock.com](http://colebrooksturrock.com)



Tel: 01303 863737



## Lyminge Baby & Toddler Group

We are excited to welcome you to our local parent, baby and toddler group.

Please come along, meet new mums and dads for a chat and a play.

It costs £3.50 with tea and coffee provided along with snacks for your child.

Tuesdays, term times only. 10am to 12noon at the Tayne Centre.

First session is free.

Follow us on Facebook and Instagram.

Contact Ellen at 07870405567.

Early Years Education & Day  
Care for Children Aged 2-5

# LYMINGE

## Pre-school

Every Day Adventures  
at our **OUTSTANDING** pre-school

**COUNTRYSIDE SETTING**  
**FANTASTIC FACILITIES & GARDENS**  
**QUALIFIED & LONGSTANDING TEAM**  
**WRAP AROUND CARE 8-5PM DAILY**  
**HOLIDAY CLUB OUTSIDE OF TERM TIME**  
**AFTER-SCHOOL CLUB**  
**PARENT PORTAL**

Rated **OUTSTANDING**  
by OFSTED 2022 

We'd love to hear from you:

 01303 863149

 [LYMINGEPRESCHOOL@GMAIL.COM](mailto:LYMINGEPRESCHOOL@GMAIL.COM)

## Etchinghill

10.15-11.30am every Wednesday  
at Etchinghill Village Hall  
£2.50 per child

Come along to Etchinghill's Parent and Toddler group welcoming all pre-school children. We have plenty of toys and snacks for the little ones, and there is always tea, coffee and cakes for the adults. For further information call Ruth on 0781777975, look at Parent and Child Etchinghill Facebook page or email us as [parentandchildetchinghill@gmail.com](mailto:parentandchildetchinghill@gmail.com).



"When your children are teenagers, it's important to have a dog so that someone in the house is happy to see you."

**Nora Ephron**







## NURSERIES AND FOREST SCHOOL

*Bridging the indoor and outdoor learning environment for children in their early years*

Badgers Bridge has three sites, set in the idyllic countryside of Postling, Lymgne and a Forest School in Lyminge. We are a small and friendly nursery, who blend the Montessori principles with the outdoor learning ethos.

### FIND US AT

-  Postling Village Hall, The Street, Hythe CT21 4EU
-  Lymgne Village Hall, Aldington Road, Hythe CT21 4LE
-  Outward Bound at Lymgne
-  Forest School in Lyminge

FROM 18 MONTHS TO  
5 YEARS

OPEN MONDAY TO FRIDAY  
8:30AM TO 3PM

GET IN TOUCH TO FIND OUT  
ABOUT AVAILABILITY AND  
MEET OUR LOVELY TEAMS  
[badgersbridge@gmail.com](mailto:badgersbridge@gmail.com)  
01303 862951







## With our excellent local knowledge & experienced staff we will get you moving

- ✓ Free professional photography, property floorplan, Rightmove premium listing & social media advertising

**01303 863393**

The Estate Office,  
8 Station Road,  
Lyminge,  
Kent CT18 8HP

Follow us on  
social media



[www.laingbennett.co.uk](http://www.laingbennett.co.uk)

## Rhodes Minnis Village Hall

Charity No.800345

Rhodes Minnis Village Hall is located 2kms (1¼miles) from Lyminge and just off Longage Hill and Whitehorse Lane in Chapel Lane.

The hall, which holds Hallmark accreditation, is ideal for children's parties, band practice, quizzes, meetings, wedding receptions, fundraising events and much more. It has a fully equipped kitchen.

### Rates

Mon to Fri £18 per session £48 all day  
Sat & Sun £23 per session  
£33 for evening session and £69 all day

### Sessions

AM session 08.30 - 12.30  
PM session 13.30 - 17.30  
Evening session 18.00 - 23.45

Separate rates for Bank Holidays and New Year and special rates for regular users.

For all bookings and enquiries please contact:

**Mick & Dorothy Athow: 01303 862616**

e-mail: [booking-rmvh@outlook.com](mailto:booking-rmvh@outlook.com)

## LYMINGE METHODIST CHURCH AND TAYNE CENTRE HALL HIRE



Church Seating Max 150 £20 per hour  
Clayson Hall (with Stage) Seating Max150 £15 per hour  
Rigden Room Seating Max 35 £10 per hour  
Wesley Room Seating Max 15 £10 per hour

All rooms have use of kitchen, toilets and disabled toilet. With the exception of Wesley room, all rooms are disabled-friendly and accessible.

Contact Tel: 07716521405 Email: [maryeblanch@outlook.com](mailto:maryeblanch@outlook.com)



*Large hall with stage, new kitchen and flexible hire*

Excellent parking facilities, disabled access, proximity to playgrounds and playing fields. Beautiful countryside location.

### Capacity:

200 people dancing / audience seating, 100 with tables  
Small rooms available for up to 50 seated

Find out how we can help you with your next event:

**BOOK ONLINE:** [lymingevillagehall.org.uk](http://lymingevillagehall.org.uk)

**EMAIL:** [admin@lymingevillagehall.org.uk](mailto:admin@lymingevillagehall.org.uk)

**INFO:** 07525 909185

Full pricing can be found on our website.

### Guideline prices:

Main Hall hire: £88.40 (Fri / Sat evenings)

£47.60 (Sat / Sun morning or afternoon)

Find us on Facebook

Registered charity 28145

## ETCHINGHILL VILLAGE HALL HIRE FEES

The next time you are thinking of holding a function why not try Etchinghill Village Hall, which holds the highest Hallmark accreditation level (Hallmark 3), with its excellent facilities, including ample parking space.

The standard hire charge for the main hall and kitchen are:

ANY DAY OF THE WEEK ANY TIME £12 PER HOUR

No winter supplements. No extra charges.

Ideal for family parties and get togethers.

The use of a separate Committee Room is also available.

For all bookings or enquiries please contact:

**The Duty Manager on 07514 758936**

## Sarah Holbrook

PAINTER & DECORATOR

## Elevate Your Space with 20 Years of Expertise

### Services Tailored to your Specification

Internal & External Work

Paper Hanging

Domestic & Commercial Undertaken

Peace of Mind - Fully Insured

Competitive Rates - Top-notch service at affordable prices

Free Quotations: Get a clear understanding of costs with no-obligation quotes.

07891743740 [sholbrookdecorating@gmail.com](mailto:sholbrookdecorating@gmail.com)

# The Lyminge Association

We're here to support and develop our community!!

## Contacts:

**Chair:** Peter Barnes 01303 863737 or  
07808775302  
pbarnes20@icloud.com

**Deputy-chair:** Dave Hunt-Cooke

**Treasurer:** Martin Fry 01303 863177  
martin@rhodesminnis.org.uk

**Minute Sec:** Heather Dunford

## Committee Members:

Marian Chubb, Richard Chubb, Dave Hunt-Cooke, Stephen Guyatt, Gillian Heywood, Robin Mackonochie, Albane McGuinness, Derek Smith, Penny Stephens, Adrian Willcox, Bernie Wood

**Newsletter:** As for Peter Barnes above.

**Please contact the Chair if you need any financial support for your charity.**

## BOYKE MANOR COTTAGES

Family-run holiday lets that have been running for 12 years

Are you looking for somewhere for a break or a longer stay?

- Two cottages available in the Elham Valley (Ottinge)
- One sleeps 6 and the other sleeps 4
- Can be let individually or together
- Fully equipped holiday cottages rated as 4 star

Provides relaxing holidays in a peaceful rural setting, close to the coast and with a wide range of places to visit in close proximity.

Ideal for a family getaway/holiday or short stays in between house purchases/whilst renovations are being undertaken.

Much more economical than hotels and the accommodation offers very high standards.

**For further details, contact Paul on 07860 452640 or visit [www.boyke-manor-cottages.co.uk](http://www.boyke-manor-cottages.co.uk)**

## Bus times

**To Folkestone town centre** via Etchinghill & Cheriton High Street  
From Lyminge, The Sidings

### MONDAYS TO FRIDAYS except Bank Holidays

There are route 17 buses at 0642, 0748, 0909, 0944, 1044, 1144, 1244, 1344, 1444, 1614 (schooldays only), 1619, 1704, 1804, and 1904.

### SATURDAYS

There are route 17 buses at 0749, 0844, 0944, 1044, 1144, 1244, 1344, 1444, 1544, 1644, 1744, 1844, and 1929.

On Mondays to Saturdays there are also route 18 buses to Sandling Station & Hythe - for times see our website or call the number below.

### SUNDAYS & BANK HOLIDAYS

There are route 17 buses at 1032, 1302, 1532 and 1802.

**To Canterbury city centre** via Elham, Barham & Bridge  
From Lyminge, Wesley Terrace

### MONDAYS TO FRIDAYS except Bank Holidays

There are route 17 buses at 0727, 0752 (school holidays only), 0903, 1003, 1043, 1143, 1243, 1343, 1443, 1613, 1733, and 1858.

### SATURDAYS

There are route 17 buses at 0742, 0842, 0943, 1043, 1143, 1243, 1343, 1443, 1543, 1643, 1743, and 1843.

On Mondays to Saturdays there are also route 18 buses to Canterbury via Stelling Minnis and Bossingham - for times see our website or call the number below.

### SUNDAYS & BANK HOLIDAYS

There are route 17 buses at 0903, 1133, 1403, and 1633.

These bus times apply from 25 September 2023.



0345 241 8000 @StagecoachSE  
customerhelpSE@stagecoachbus.com  
stagecoachbus.com

## Coach & Horses

### CHECK OPENING HOURS

For bookings and any help needed, please phone

01303 901011 or check

Facebook page 'Coach & Horses'



Find us on

facebook

## Lyminge Library Opening Times

Monday 10am - 2pm  
Tuesday 12noon - 5pm  
Wednesday 10am - 2pm  
Thursday 10am - 5pm  
Friday 10am - 2pm  
Saturday 9am - 1pm

Tel: 03000413131 [lymingelibrary@kent.gov.uk](mailto:lymingelibrary@kent.gov.uk)

**DAVID HAIME**  
ARCHITECTURAL TECHNOLOGIST  
BUILDING TECHNICAL DESIGN  
AND CONSTRUCTION DRAWING  
SERVICES.  
PROJECT MANAGEMENT

**CIAT**  
Registered Practice  
Chartered Institute of Architectural Technologists

BUILDING PLANS FROM PORCH TO NEW BUILD.  
PLANNING/BUILDING CONTROL/STRUCTURAL CALCS.  
COVERING KENT/SUSSEX/SURREY.

LYMINGE, KENT CT18 8HA  
TEL: +44 7974 156510  
EMAIL: D.HAIME@BTINTERNET.COM

Editor: pbarnes20@icloud.com

**Kingdom**  
CARPET CO.

- Carpets Supplied & Fitted
- Carpets Professionally Cleaned
- Carpets Whip Edged & Cotton Bound

Whatever your carpet need, give us a call for a **FREE** estimate / assessment.

Over 50 years combined experience.

07943 764 442  
Email: [kingdom.carpet.co@gmail.com](mailto:kingdom.carpet.co@gmail.com)

**GEORGE MILLER**  
BOILER & HEATING ENGINEERS

- Gas & Oil Boilers
- Central Heating
- Hot Water Systems

01303 901070  
[service@georgemiller.co.uk](mailto:service@georgemiller.co.uk)  
248 Cheriton Road,  
Folkestone, CT19 4DN

[georgemiller.co.uk](http://georgemiller.co.uk)

Tel: 01303 863737



## Financial Planning

**David Gridley - Chartered Financial Planner**

Range of quality advice from a fully qualified adviser:

- Pre- and Post-Retirement Planning
- Investment Planning
- Inheritance Tax Planning

For further information, please contact our Lyminge office

David Gridley FPFS

Tel: 01303 863959 Email: davidgridley@sjpp.co.uk

**MWH**

Window and gutter cleaning service

**Mark Haley**



Lyminge and surrounding areas

For a free no obligation quote, please contact me

Mobile: 07738 479202

Home: 01303 863 702 Email: haleymark161@gmail.com

Find us also on Facebook

**Ashman Consulting Ltd**



**Straightforward I.T.**

**Advice  
Training  
Solutions  
Support**

**Steve Ashman**

**07702641981**

**info@ashman-consulting.co.uk**

**T. Metcalfe Fencing Contractors**

Approved Expert Installer for Jacksons Fencing

Established over 30 years

Fully insured - Highly experienced teams



Panel fencing, gates, decking, pergolas, post & rail, stock fencing, security, landscaping & tree surgery.

**01303 840201 07790 290 155**

metcalfefencing@btinternet.com

Proprietor - Derek Burr,  
Ash Ridge House, Elham



## Fincham Plumbing & Heating

We specialise in bathroom remodelling, including all tiling & pipework

Natural gas boiler servicing, Installation, Maintenance, Repairs, Replacement

All your plumbing requirements

Martin is a Qualified Plumber & Gas Engineer with over 30 years experience

Gas Safe, CIPHE, WIAPS registered

**Rosemary & Martin Fincham**

**07835 851 706 martinfincham@sky.com**



**Lou Lloyd**

**Carpenter**

**loulloyd@rocketmail.com**

**07984 426214**

**Kitchens, Flooring, Wardrobes,  
Doors, Decking and more!**

**HAND MADE CURTAINS,  
ROMAN BLINDS & SOFT  
FURNISHING**

**CURTAIN ALTERATIONS**

**TEL: VALERY WREN 0781 1563512**



**D & S DOUBLE GLAZING SERVICES**

01303 863689 - 07912317915

We are a local company that specialise in double glazing repairs offering a wide range of service's that include: Replacement double glazed units - Locks - Hinges - Handles - Rubber Seals - Gaskets.

For a free estimate please call: 07912317915 or 01303 863689

or email: dsdoubleglazingservices@gmail.com



**CEDAR TREE CARE** City & Guilds

All types of tree work undertaken NPTC

Crown lifting, crown reductions,

dismantling and removals, hedge maintenance,

pollarding, stump grinding and removal, mobile saw milling,

wood land maintenance, all year round seasoned logs available

Fully insured and NPTC qualified with over 15 years experience

Call Tom: 07769 908027 email: linchlogs@gmail.com

**SPEARPOINT**  
TREE SERVICES

All Aspects of Tree Work Undertaken  
NPTC Qualified  
Fully Insured  
Please call **Shane** for a Free Quote  
**07963 203564** or  
**01303 621992**

**B.M. Plumbing & Maintenance Services**

Local Lyminge Tradesman

Plumbing and heating works. Complete bathroom install including tiling. General building maintenance undertaken. No job too big. No job too small.

Cheaper rates for senior citizens

**07890854128 Benmillsplumbing@hotmail.co.uk**



FULLY INSURED

Dog training and Pet care services

- Puppies from 12 weeks old
- Kennel Club Good Citizen Dog Scheme Puppy through to Gold
- 1-2-1 home-based puppy training also available
- Other pet care, dog walking and day cover available
- Other fun classes available - ask for details

Lyn Fagg 07866 234820

Email: Elhamdtc@gmail.com



FULLY INSURED



## Snippers and Clippers Barbers - Lyminge

Please call Richard for availability on  
**07522 494969**

*Appointments not always necessary*

4 Station Road, Lyminge CT18 8HP

## Andy Mannering Flooring

SPECIALISING IN AMTICO AND KARNDEAN LUXURY VINYL TILES

- Also safety flooring, rubber flooring, etc.
- Commercial and domestic work undertaken
- No job too small
- Free estimates and advice given
- Over 35 years experience
- Fully insured



**Telephone:** 0797 434 7248 or 01303 863095

**Email:** info@andymanneringflooring.com

Please visit my website for further information and feedback

**www.andymanneringflooring.com**

## DILTON

### MINI SKIP HIRE



Ballast, Hardcore, Sand and Topsoil Supplied

REGISTERED WASTE CARRIER

**01303 812448 or 07799 433754**

## Red Dragon I.T. Ltd.



- Windows, Mac & Linux Systems
- PC Health Checks
- Wired & Wireless Networks
- Website Design
- Graphic Design

T: 01303 723456 | E: info@rdit.co.uk | www.rdit.co.uk  
The Old Granary, Hanover Mill, Church Rd, Mersham, TN25 6NU

*'Helping you enjoy your garden'*

## CRT Gardening

All general garden and major landscaping redesign work will be undertaken including: full or minor garden design, hard and soft landscaping, new fencing and decking installation and repairs as we are Jacksons Fencing approved installers, hedge trimming and cutting, small to medium tree work.

For a free quotation call or text Karl Dodd on 07967 442518 or email karl.dodd@live.co.uk

Fully Insured

## Rhodes Minnis Cat Sanctuary



REHOMING & BOARDING CATTERY

- Our Sanctuary takes in and rehomes 250 unwanted cats and kittens each year.

A variety of cats are always available to suitable homes.

- 5\* Boarding Cattery under 2018 regulations

- We are open to visitors every day from

10am-1pm & 2-4pm. No appointment needed.

T: 01303 862 243

E: rhodmminiscats@gmail.com

Facebook: @rhodmminiscats

www.rhodmminiscatsanctuary.com



Seathwaite, Green Lane, Rhodes Minnis, Kent. CT4 6XU  
Reg. Charity No. 262245



Hawkinge

## Veterinary Surgery

Independently owned veterinary surgery for all types of small animals.

Opening hours: Monday to Friday 08:00-19:00 Saturday 08:30-13:00

24hour emergency service

TEL: 01303 764190

Hawkinge Veterinary Surgery, 9b Defiant Close, Hawkinge CT18 7SU

www.hawkingevetsurgery.co.uk



**ROBERT KENT** Cert. fp  
FUNERAL DIRECTOR

Direct Cremation

£999

Fair Priced Cremation

£1950

ONE FIXED PRICE INCLUDING ALL CREMATION FEES

01303 684062

**RKFUNERALS.COM**

## SCRUBBERS - Est. 1988

THE HOME AND COMMERCIAL CLEANERS

One off, regular or moving day 'Blitz'

Oven cleaning - Ironing

Carpet cleaning and more...

For a friendly and reliable service

Free Estimates

Tel: 01303 249288 or 07834 128671

## Computer support & repairs by local people

*Customer service is our priority*

- \*Remote IT support for business or home
- \*New & refurbished sales
- \*Call-outs for business or domestic users
- \*Preventative maintenance & upgrades
- \*Repairs to most phones, tablets & devices

enquiries@thecomputerpeopleltd.co.uk



Church Approach,  
New Romney,  
TN28 8AS  
01797 363385



Acrise Electrical Services Limited

Design - Install - Maintain

Tel: 01303 656007 Mob: 07803 421240

Email: info@acrise-electrical.co.uk

Website: acrise-electrical.co.uk

*Domestic, commercial, industrial & agricultural electricians serving the Elham Valley and surroundings.*

## Tressenden Designs

A seamstress and costume maker with 8 years of experience.

- ♦ Clothing alterations ♦ Repair work undertaken ♦ Made-to-measure; create a bespoke piece for those special occasions
- ♦ Modern and vintage designs ♦ Costumes, ball gowns and wedding dresses

For more information or a quote please contact Amy on: Mobile: 07853 202304 Email: amy.louise.ford@hotmail.co.uk







## T.M. GRIGGS

01303 489795 07854 098395  
tobystreesurgery@gmail.com



**Garden Clearance - Turfing - Hedge Cutting  
Tree Work - Stump Grinding - Fence Repair**

## FRESHLOOK GARDENS

Regular lawn mowing service. Garden design. Hard and soft landscaping. General garden work, fencing and decking. Turfing hedge cutting, small and medium tree work. Water features, ponds and patios.

For free quotation ring **Danny Scott**  
**01303 242140** or **07795510093**  
**mrdanscott89@gmail.com**

Established since 1990. Fully insured.

## DYNO-ROD



We've been  
unblocking  
sinks, drains  
& toilets  
in Kent  
since 1965

- Quick Response
- CCTV Drain Inspections
- Drainage Repairs
- Pre-purchase Surveys

For a FREE no obligation quote  
contact Mark or Peter on:

**01233 621108**  
**07557 616630**

## THE HANDY FELLOW



**A TRUSTED LOCAL SERVICE**  
**CALL 07534485049**  
**ONE.HANDY.FELLOW@GMAIL.COM**

## Computer Repairs

01303 241325  
07968 129902

PCs, MACs, Laptops, Tablets & printers,  
Upgrades & Repairs, Internet & Email, virus removal,  
Office Setup, Backup & Recovery & much more ...  
Tuition available by a qualified tutor.

Usual Fee **£55**

Web sites built & hosted from £10 per month

See [www.computers-in-lyminge.co.uk](http://www.computers-in-lyminge.co.uk) for details



General Landscaping Including  
Fencing • Turfing • Paving

**Gavin Allfree**

T 07495 299711 E [gavinallfree@gmail.com](mailto:gavinallfree@gmail.com)

## C. Brewer

**Painting and Decorating  
Interior and Exterior Painting**

15 years of experience ~ a keen eye for detail  
Clean and tidy worker

Good rates and senior citizens discount of 10% off labour

**07510 631497**

Local Tradesman

## J Tappenden

Established over 40 years ago



Painter/Decorator

**01303 862467**

**077755 78008**

## Hamilton Windows & Doors

*New joinery, restoration, double glazing of old and  
existing timber windows*

Bring your windows and doors back to life and get rid of  
cold draughts, or replace them with beautiful new ones.

Joiner/carpenter with many years of experience.

Based in Lyminge, please feel free to call for more information.

**07792901266** [Alex\\_b\\_hamilton@live.co.uk](mailto:Alex_b_hamilton@live.co.uk)

## Jackson Plumbing Property Maintenance

*Complete bathrooms and tiling  
No job too small. Special rates for OAP's.*

**Telephone: home/evening 01303 270691  
or daytime 07773 089398 or 07864 929826**

## Trevor Law Electrical Installations



Serving Elham Valley for 30 years  
Part P Registered

**07850 970087**

**To advertise in this space, please contact**

**Peter Barnes**  
[pbarnes20@icloud.com](mailto:pbarnes20@icloud.com)  
**01303 863 737**  
**07808 775 302**



## JBS BUILDERS

Specialising in Brickwork, Fencing, Landscape Gardening. Tree work undertaken (lopping,  
felling and clearing).

General household repairs, painting, plastering, power jetting & cleaning.

No job too small!!! All work guaranteed and insured.

**For free advice and quotations please call: 07825 168010/ 01303862361 (anytime)**





**APX PROJECT  
MANAGEMENT**

From design to build, we use trusted quality trade professionals along with reliable suppliers to ensure budgets are met, with high standards maintained. If you're looking to -

- Extend your property
- Carry out an external or internal refurbishment
- Convert an existing building into a new dwelling

Please contact: paul@apxprojectmanagement.co.uk 07487 364155



**Dennis Huntley**  
Chimney Sweep



Wood burners and multifuel stoves installed  
Hearths and fireplaces built & installed  
Over 40 years' experience

**01303 862 343 • 07850 784 365**

dennis.huntley@talktalk.net www.dennishuntley.co.uk



## Auto Economy Centre

**Fully equipped Mechanical Repair & Service Centre**

**With the latest diagnostic equipment**

**Half price MOTs when booked with any service**

**01303 863656**

**Orchard Garage, Canterbury Rd, Etchinghill**

**www.autoeconomycentre.com**

## AIR LINK CARS

(You pack up, we pick up)

Airport, Seaport & Long Distance Travel Specialists.  
The Family Run Business where service really counts  
Estate cars and People Carriers



Fixed price 24hrs a day. No extras.  
Written Confirmation of booking.

For the Easy Airport Link, Think AIR LINK!  
**01303 670370 - 07766 824 474**  
airlinkcars@yahoo.com

**Gosbee**  
LANDSCAPES

FENCING | GATES | PAVING | RESIN BONDING  
• Over 35 years experience • Jacksons Approved Installer  
• Marshalls approved • Check-a-trade registered

Call Martin Gosbee: 07974 835 511 | 01303 863 337

GOSBEECONSTRUCTION@GMAIL.COM  
GOSBEE.CO.UK

## D.W. Garden and Mini Digger Services

**Mowing, Fencing, Hedge Cutting,**



**Chainsaw Work, Turfing**

**Free Quotes**

**Contact David 07765789721**

**KW CONSTRUCTION**  
PLASTERING & RENDERING SPECIALIST

ALL GENERAL BUILDING INCLUDING:  
ROOFING, BRICKWORK, TILING, PATIOS,  
LANDSCAPING, SCREEDING, GROUNDWORK,  
DRAINAGE, EXTENSIONS, RENOVATIONS,  
REPAIRS & MAINTENANCE.

30 YEARS EXPERIENCE, COMPETITIVE RATES,  
A FULLY INSURED, PROMPT & RELIABLE  
HIGH QUALITY LOCAL BUILDER

KENNY 07743488361

**HANDYMAN**  
SERVICES  
SJW

www.Facebook.com/sjwoodhandyman  
www.Instagram.com/sjw.handymanservices  
**07796 384857**

## LYMINGE FOOD & WINE

**01303 862225**



Our new opening times are:

Mon – Sat **7:00-20:00**

Sunday & Bank Holidays

**8:00 - 19:00**

PayPoint

POST  
OFFICE



We offer National Lottery, ATM terminal,  
Post Office & PayPoint services.



**AK Healthcare**

Registered Osteopaths

Tel: 07904311554 /  
07980897382

www.akhealthcare.org.uk

As osteopaths, Adam and Katie can help patients suffering from a wide variety of conditions including arthritic pain, circulatory problems, frozen shoulder, back pain, sciatica and much more. Please visit our website or give us a call for more information.

**AK Healthcare,  
Garden Suite,  
4 Station Road, Lyminge**

## Park House Sanctuary Boarding Kennels & Cattery

**Park House, Stelling Minnis CT4 6AN**

Brick-Built Heated Kennels. Daily Walks ~ Reasonable Rates

Dogs must be fully inoculated. Heated Cat Chalets

Quiet Area Inspection Invited.

To book or for further information, call 01303 862622

or email lord.whisky@btinternet.com

www.lordwhisky.co.uk

## South East Aerial & Satellite Solutions

Digital – Freeview – Satellite – Aerials

Supply and fit of quality digital installations, FREEVIEW, SKY, aerials, poor reception and problem solving, upgrades and repairs by fully accredited engineers

Free quotations and advice, fixed prices, fully insured



**NO CALL-OUT CHARGE**  
**07825 168010 - 01303 862361**

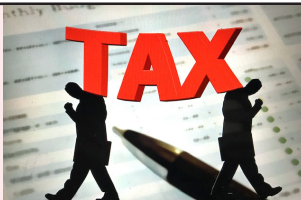

Based in Etchinghill, I provide a personalised service with a one-off, flat fee of £180 to prepare & submit your Tax Return. No hidden costs.

FMAAT Licensed Accountant, fully insured and HMRC-authorized.

Contact Anita:

**07361 238744 or aabookkeepingservicesadams@gmail.com**



## D.M.B. Plastering

All aspects undertaken  
*Interior. Exterior. Plastering. Rendering.  
Coving. Ceilings. Wall. Floors  
Finest quality assured. CSCS Certified.*  
30 years experience.  
Free estimates. Reliable service. Fully insured.  
Call **David** on **07818 607209**

## Sunhouse Electrical

Your local reliable Electrician  
Part P Registered & Elecsa Approved  
On Electrical Safety Register & Fully Insured  
For a free quotation call James on  
**01303 766333**  
[www.sunhouse-electrical.com](http://www.sunhouse-electrical.com)

## KJB GARDEN SERVICES

Weeding, Pruning, Mowing, Hedge  
Cutting & General Maintenance  
**01303 862181** or **07704 989 402**  
**Over 35 years experience**

House Clearance covering South East Kent.....and beyond!  
**CAROL CREES CLEARANCES**



- Est. over 30 years  
Full/part house clearance  
Fair prices paid  
Antique/Vintage/Retro/Modern  
Registered rubbish carrier

Contact **Simon Cullen** on **07745 421680** or [sijnzo@aol.com](mailto:sijnzo@aol.com)

Total garden care for all your needs

## TIM MILLETT

Grass Maintenance, General Gardening, Small & Medium  
Size Tree Work, Stump Grinding and Wood chipping  
Fencing Repairs & New Installations  
Turfing, Hard & Soft Landscaping  
Free Estimates - Fully Insured

**07752 880583**

Email: [info@tmhorticulture.co.uk](mailto:info@tmhorticulture.co.uk)

## N.P.C.

### Domestic Appliance Services

*Service and repair of washing machines, tumble driers,  
dishwashers, cleaners and small electrical work.  
For a prompt and friendly service*

Call Neil Collard 01303 892234 or 07798716044  
or Google me on Yell.com

# Ewin Electrical

Contact Simon for any electrical maintenance, refurbishments or  
upgrades with a friendly, clean and professional approach to work  
**07891103065**

[info@ewinselectrical.co.uk](mailto:info@ewinselectrical.co.uk) [www.ewinselectrical.co.uk](http://www.ewinselectrical.co.uk)



## SNIPPERS & CLIPPERS UNISEX HAIR SALON

APPOINTMENT NOT ALWAYS NEEDED

WEDDINGS & SPECIAL OCCASIONS

SHELLAC NAILS

FREE WIFI

GENTS WELCOME

4 Station Road, Lyminge  
Folkestone  
Kent, CT18 8HP

01303 647 222

[info@snippersandclippers.co.uk](mailto:info@snippersandclippers.co.uk)

Find us on  
Google+

Find us on:  
facebook



## East Kent Foot Care

[www.eastkentfootcare.co.uk](http://www.eastkentfootcare.co.uk)



## 07745 532075 Podiatry, Chiropody, Foot Health

Treating and managing foot  
and nail conditions, corns,  
callus, insoles, ingrown nails,  
diabetic foot care



## Your Local Electrician For all your electrical needs

- 18th Edition/Part P Registered
  - Insured & all work guaranteed
  - All electrical work carried out including EV charging points
  - Covering Lyminge, Etchinghill & surrounding villages
- Call for a free, no obligation quote and to discuss your  
electrical requirements.

Proud members of  
**Checkatrade.com**  
Where reputation matters



**07878 457018**

**01303 814372**

[info@hughes-electrical.co.uk](mailto:info@hughes-electrical.co.uk) [www.hughes-electrical.co.uk](http://www.hughes-electrical.co.uk)

## JON DAUGHTERS - Local Builder

All aspects of general building works undertaken including: roofing, kitchens, bathrooms and small extensions  
**Trading for over 30 years Free quotes, no obligations, fully insured**  
**Telephone: 01303 863371 Email: daughters777@hotmail.co.uk**



## LYMINGE THEN AND NOW

Our monthly look at how Lyminge has changed over the years, with thanks to Lyminge Historical Society.



Following July's Lyminge Then and Now, we are returning to Yew Tree Cross this month to look at it from another angle. The picture on the left is taken from a postcard franked with the date 19 September 1907. The photographer standing in front of the traffic then was in somewhat less danger than the photographer in 2024 who had to avoid cars swinging round the corner from Canterbury Road heading towards Sibton Park.

Prominent in the older photo on the left is what was known at the time as numbers 1 and 2 Sibton Gate, although in the 1921 Census it was called Mill Cottages. They were built sometime between 1840 and 1870. In 1911, no 1 was lived in by Alfred Wiles, a gamekeeper, and his wife Susan. No 2 was occupied by John Hooker, a widowed shepherd with his adult daughter Elizabeth and two sons Ernest and Claude. This building was demolished in the 1960s to make way for the bungalows that now front on to this stretch of road. Behind the cottages the White Windmill built in 1860 is visible. This was demolished in 1920 after it became unsafe. An older black windmill also used to stand close by, but this burned down in 1891.

The Sibton Park Estate was allowed to put gates on the road to prevent cattle from straying. These gates were normally kept closed into the late 1960s and traffic had to stop in order to open them. They were still standing into the 1990s, though by then they were kept permanently open. They have since decayed to nothing and there are no traces left. Fragments of the metal estate fencing, clearly visible and intact in the older photograph can however still be seen.

## Rhodes Minnis Village Hall Summer Show

Our August Summer Show was a great success with entries way above previous years. It has been a challenging time with so much rain earlier in the year followed by a lack of it during the past few months. However, we are grateful to all the people that take the time to enter and make it possible for us to continue.



### Cup Winners

**Harrowing Cup** - Dorothy Athow - Exhibitor with most points in the show.

**Bennett Shield** - Sara Packer - Best exhibit in the show.

**Saxby Cup** - Colin Lambert - Most points in the Vegetable section.

**Wiltshire Cup** - Dorothy Athow - Most points in the Flower section.

**Griffiths Cup** - Carol Lambert - Most points in the Domestic section.

**Woodruff Trophy** - Gill Broadley - Most points in the Floral Art section.

**RMSC Trophy** - Colin Lambert - Most points in the Photographic section.

**Athow Tankard** - Dorothy Athow/Gill Broadley - Most points in the Craft section.

**Killick Cup** - John Packer - Sweet Peas.

**Flack Cup** - Carol Lambert - Perfumed Rose

**DT Brown Cup** - Rebecca Austin - 3 Stages of a bloom

## Lyminge Gardeners' Society Summer Show

Lyminge Gardeners' Summer Show took place on 20th July and despite the challenges of this year's weather was well supported with wonderful flowers and floral art as well as baked goods, photographs and vegetables. There was also very successful plant sale along with home-made cake for visitors in the afternoon.





## Lyminge Library Garden Project

We would like to say a massive thank you to our volunteers, **Veronica** and **Linda**, who have transformed the front and back garden of the library. Their hard work has created a lovely space for the community to come and enjoy.

Thank you also to the **Lyminge Association** who provided funding to the individuals involved, to the **Gardeners' Society** and **Maureen Lewsey** who provided plants, to **Mr and Mrs Laverty** for their benches, to **Fred** from the Parish Council for making them look new and shiny and to other members of the Lyminge community who have provided garden items.

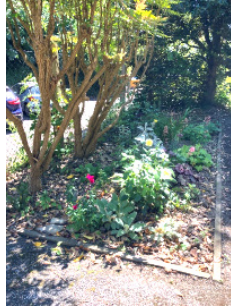

## Lyminge Friends Summer Lunch

**Lyminge Friends** hosted a lovely Summer Lunch on the 8 August and the sun actually shone. It was held at Lyminge Church and the Rector, Carol Bates, joined the group. Everyone enjoyed great food generously donated by members of Lyminge Friends and local friends and families. Lyminge Friends made a donation to the church to thank them for kindly allowing us to use the Church and gardens. A good time was had by all.



## Sibton Park Cricket Club

to over 70 children that turn up every Friday evening, come rain or shine, to practise, with this year proving that *'practice really does make perfect'*.

All teams have had their own successes in one shape or form. The Under 15s squad won both the Ashford U16 B league and the Saxon Shore U15 League whilst the U13s won the Ashford U13 A League and came 1st and 2nd in the Saxon Shore U13 League. Not to be outdone in their first season together

the U11 and U9 teams both celebrated their first wins and are both

through to the finals of the Kent Forty Softball Tournament in September. Some of our older juniors have also enjoyed their first season playing in the seniors for our new Saturday 2s team and are doing incredibly well.

I hope you can agree that there is no other club in Kent as beautiful as the one we have on our doorstep. No matter what age you are, if you are interested in cricket please come and support our family friendly club.

Junior training continues every Friday night throughout the summer from 6pm-7:30pm, with the bar open to enjoy. There are home matches for the senior teams every Saturday.

To keep up to date with news from 'The Park' join our Facebook page.

## Cricket Success at Sibton Park

As the sun came down on yet another successful junior cricket week and the live music continued into the night, there was no other place to be at the end of a gorgeous summer's evening than the stunning Sibton Park Cricket Club. With over 35 games of cricket played and countless runs scored, there was a lot to celebrate.

It has been another impressive season for all involved at Sibton Park Cricket Club, in particular the ever-growing junior section. This year the junior section has grown

